

Radius RA SMA Female to SMA Female Adapter Gold Plated

Radius RA SMA female to SMA female adapter part number SM5284 from Fairview Microwave is in-stock and ships same day. This Fairview SMA to SMA adapter has a female to female gender configuration. SM5284 SMA female to SMA female adapter operates to 18 GHz. The Fairview Microwave RF adapter provides excellent VSWR of 1.25:1 maximum. The SMA connector mates mechanically with commercially available 3.5mm and 2.92mm (K) connectors. This radius right angle SMA adapter allows for easier connections in tight spaces.

RF adapters can be used to enable connections between two connector types that would otherwise not mate. Certain RF adapter configurations can also be used to protect connectors on expensive equipment where the number of connect and disconnect cycles is high. An RF, microwave, or millimeter wave adapter is connected to the equipment and the commonly changed connection is made with the adapter which can be easily replaced when it wears out after high usage; such adapters are referred to as connector savers. Fairview Microwave also offers bulkhead, panel mount, hermetically sealed, reverse polarity, and isolated ground adapter varieties to serve all of your RF, microwave and millimeter wave needs.

Electrical Specifications

Description	Min	Typ	Max	Units
Frequency Range	DC		18	GHz
VSWR			1.25:1	
Operating Voltage (AC)			335	Vrms
DWV (AC)			1,000	Vrms
High Potential Voltage (at 5 MHz)			670	Vrms
Corona Discharge (at 70,000 ft)			250	Vrms
Inner Conductor DC Resistance			3	mOhms
Outer Conductor DC Resistance			2	mOhms
Insulation Resistance	5,000			MOhms
RF Leakage			-72	dB

Electrical Specification Notes:

Values at 25°C, sea level.

RF leakage = -(90 - fGHz) dB max.

Mechanical Specifications

Size

Length	0.46 in [11.68 mm]
Width	0.46 in [11.68 mm]
Weight	0.0075 lbs [3.4 g]

Description	Connector 1	Connector 2
Type	SMA Female	SMA Female
Polarity	Standard	Standard
Interface Specification	MIL-STD-348	MIL-STD-348
Mating Cycles	500	500



Configuration:

- SMA Female Connector 1
- SMA Female Connector 2
- 50 Ohm
- Radius Right Angle Body Geometry

Features:

- VSWR of 1.25:1 max up to 18 GHz
- SMA interface meets MIL-STD-348
- Contact plating according to ASTM B-488
- Gold Plated Beryllium Copper Contact

Applications:

- General Purpose Test

Fairview Microwave
301 Leora Ln., Suite 100
Lewisville, TX 75056
Tel: 1-800-715-4396 / (972) 649-6678
Fax: (972) 649-6689
www.fairviewmicrowave.com
sales@fairviewmicrowave.com

Material Specifications

Description	Connector 1	Connector 2
Type	SMA Female	SMA Female
Contact Material	Beryllium Copper	Beryllium Copper
Contact Plating	Gold	Gold
Contact Plating Spec.	ASTM B-488	ASTM B-488
Insulation Material	PTFE	PTFE
Outer Contact Material	Stainless Steel	Stainless Steel
Outer Contact Plating	Gold	Gold
Outer Contact Plating Spec.	ASTM B-488	ASTM B-488

Environmental Specifications

Temperature

Operating Range

Humidity

Shock

Vibration

Salt Spray

-65 to +165 deg C

MIL-STD-202, Method 106

MIL-STD-202, Method 213, Test Condition I

MIL-STD-202, Method 204, Test Condition D

MIL-STD-202, Method 101, Test Condition B

Compliance Certifications (see [product page](#) for current document)

Plotted and Other Data

Notes:

Typical Performance Data

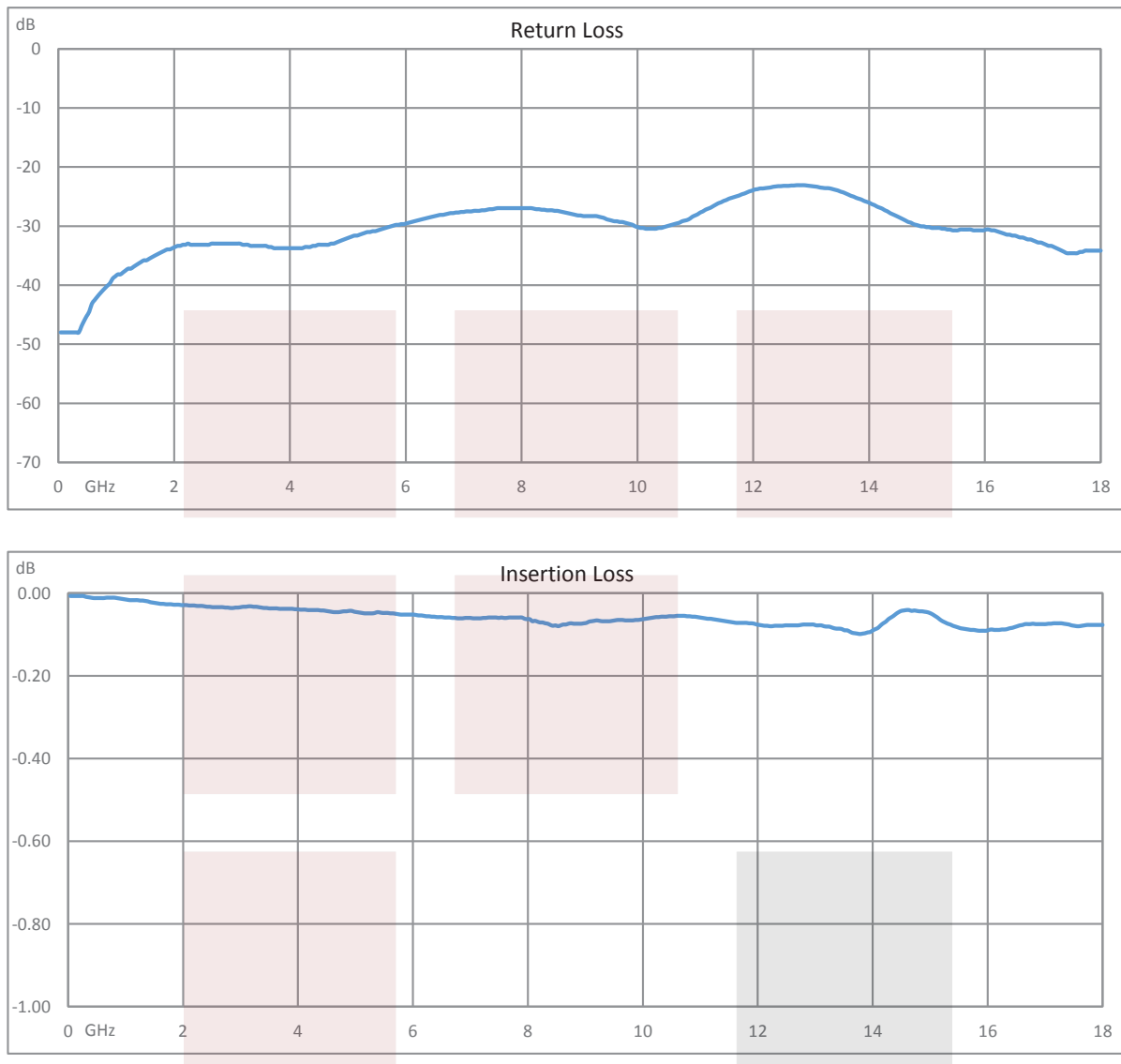

Radius RA SMA Female to SMA Female Adapter Gold Plated from Fairview Microwave is in-stock and available to ship same-day. All of our RF/microwave products are available off-the-shelf from our ISO 9001:2008 certified facilities in Allen, Texas. Fairview Microwave is RF on-demand.

For additional information on this product, please click the following link: [Radius RA SMA Female to SMA Female Adapter Gold Plated SM5284](#)

URL: <https://www.fairviewmicrowave.com/radius-ra-sma-female-sma-female-adapter-sm5284-p.aspx>

The information contained in this document is accurate to the best of our knowledge and representative of the part described herein. It may be necessary to make modifications to the part and/or the documentation of the part, in order to implement improvements. Fairview Microwave reserves the right to make such changes as required. Unless otherwise stated, all specifications are nominal. Fairview Microwave does not make any representation or warranty regarding the suitability of the part described herein for any particular purpose, and Fairview Microwave does not assume any liability arising out of the use of any part or documentation.

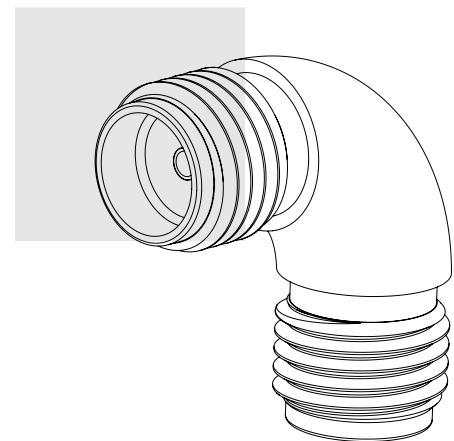
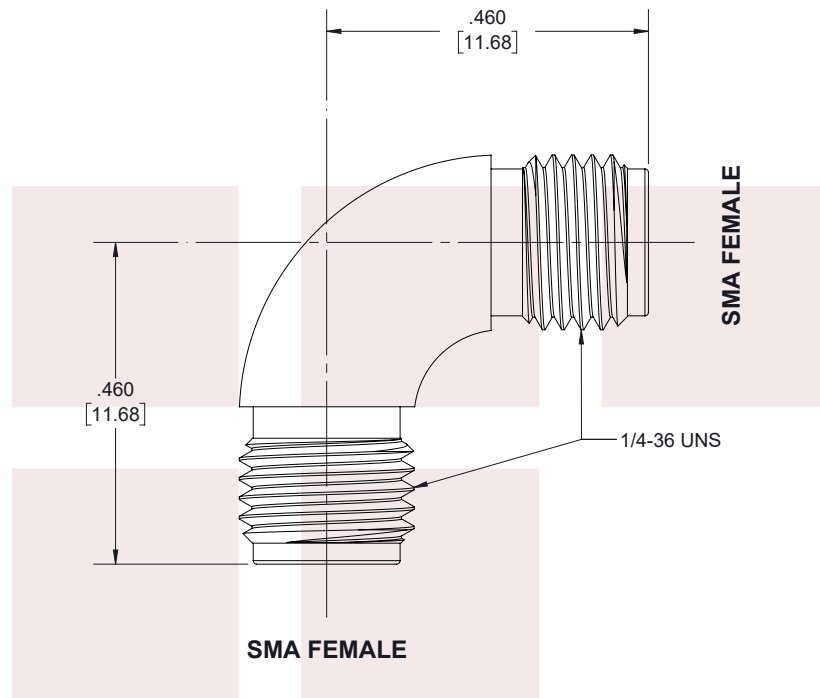

STANDARD TOLERANCES

.X	±0.2
.XX	±0.01
.XXX	±0.005

*STANDARD TOLERANCES APPLY
ONLY TO DIMENSIONS IN INCHES

Fairview Microwave RF COMPONENTS ON DEMAND. <i>Done!</i>		NOTES: 1. UNLESS OTHERWISE SPECIFIED ALL DIMENSIONS ARE NOMINAL. 2. ALL SPECIFICATIONS ARE SUBJECT TO CHANGE WITHOUT NOTICE AT ANY TIME. 3. DIMENSIONS ARE IN INCHES [mm].				
TITLE Radius RA SMA Female to SMA Female Adapter Gold Plated	DWG NO SM5284		CAGE CODE 3FKR5			
	CAD FILE 05/23/18	SHEET 1 OF 1	SCALE N/A	SIZE A	7361	