

## SMA Female to GMS Male 2 Hole Flange Adapter with Passivated Stainless Steel Body

SMA female to GMS male 2 hole flange adapter part number SM2924 from Fairview Microwave is in-stock and ships same day. This Fairview SMA to GMS adapter has a female to male gender configuration and is built of durable stainless steel. SM2924 SMA female to GMS male adapter operates to 23 GHz. The Fairview Microwave RF adapter provides excellent VSWR of 1.25:1 maximum. The SMA connector mates mechanically with commercially available 3.5mm and 2.92mm (K) connectors. Our RF SMA to GMS 2 hole flange adapter allows designers to create external connections on their product enclosures, and can be used in a variety of other rack mount and panel mount applications.

RF adapters can be used to enable connections between two connector types that would otherwise not mate. Certain RF adapter configurations can also be used to protect connectors on expensive equipment where the number of connect and disconnect cycles is high. An RF, microwave, or millimeter wave adapter is connected to the equipment and the commonly changed connection is made with the adapter which can be easily replaced when it wears out after high usage; such adapters are referred to as connector savers. Fairview Microwave also offers bulkhead, panel mount, hermetically sealed, reverse polarity, and isolated ground adapter varieties to serve all of your RF, microwave and millimeter wave needs.

### Electrical Specifications

Description	Min	Typ	Max	Units
Frequency Range	DC		23	GHz
VSWR			1.25:1	

### Mechanical Specifications

Size		
Length		0.9 in [23.8 mm]
Width		0.359 in [9.12 mm]
Height		0.65 in [16.51 mm]
Weight		0.0115 lbs [5.22 g]

Description	Connector 1	Connector 2
Type	SMA Female	GMS Male
Polarity	Standard	Standard
Mating Cycles	5,000	5,000

### Material Specifications

Description	Connector 1	Connector 2
Type	SMA Female	GMS Male
Contact Material	Beryllium Copper	Beryllium Copper
Contact Plating	Gold	Gold
Insulation Material	PTFE	PTFE
Body Material	Passivated Stainless Steel	Passivated Stainless Steel



### Configuration:

- SMA Female Connector 1
- GMS Male Connector 2
- 50 Ohm
- Straight Body Geometry
- 2 Hole Flange Mount Method

### Features:

- VSWR of 1.25:1 max up to 23 GHz
- Gold Plated Beryllium Copper Contact

### Applications:

- Enables Between Series Connections
- General Purpose Test
- Rack Mounted Equipment

Fairview Microwave  
301 Leora Ln., Suite 100  
Lewisville, TX 75056  
Tel: 1-800-715-4396 / (972) 649-6678  
Fax: (972) 649-6689  
[www.fairviewmicrowave.com](http://www.fairviewmicrowave.com)  
[sales@fairviewmicrowave.com](mailto:sales@fairviewmicrowave.com)

## Environmental Specifications

### Temperature

Operating Range -65 to +165 deg C

**Compliance Certifications** (see [product page](#) for current document)

## Plotted and Other Data

Notes:

### Typical Performance Data

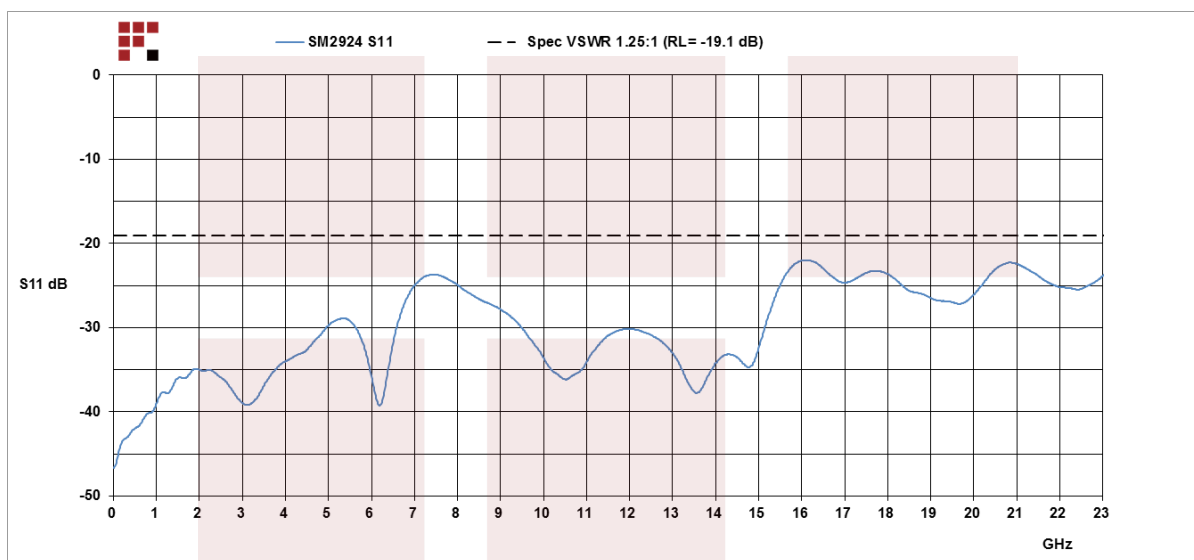

SMA Female to GMS Male 2 Hole Flange Adapter with Passivated Stainless Steel Body from Fairview Microwave is in-stock and available to ship same-day. All of our RF/microwave products are available off-the-shelf from our ISO 9001:2008 certified facilities in Allen, Texas. Fairview Microwave is RF on-demand.

For additional information on this product, please click the following link: [SMA Female to GMS Male 2 Hole Flange Adapter with Passivated Stainless Steel Body SM2924](#)

URL: <https://www.fairviewmicrowave.com/sma-female-gms-male-2-hole-flange-adapter-sm2924-p.aspx>

The information contained in this document is accurate to the best of our knowledge and representative of the part described herein. It may be necessary to make modifications to the part and/or the documentation of the part, in order to implement improvements. Fairview Microwave reserves the right to make such changes as required. Unless otherwise stated, all specifications are nominal. Fairview Microwave does not make any representation or warranty regarding the suitability of the part described herein for any particular purpose, and Fairview Microwave does not assume any liability arising out of the use of any part or documentation.

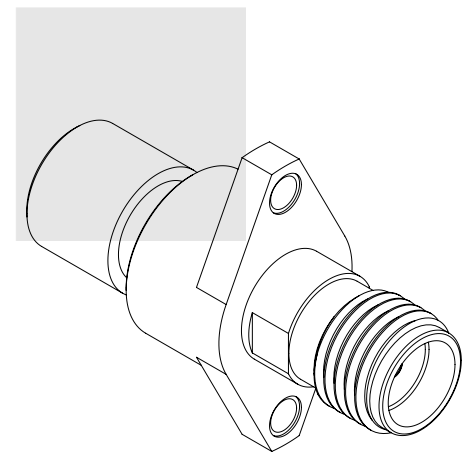
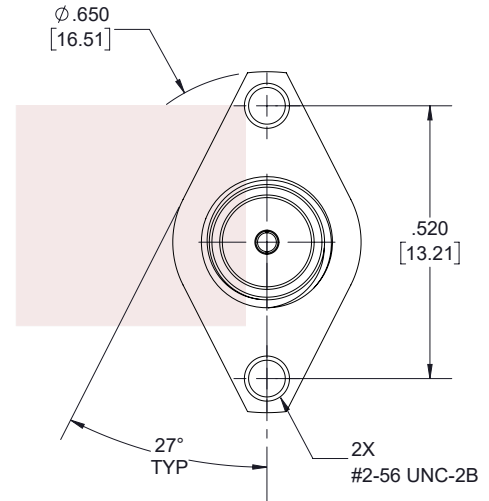
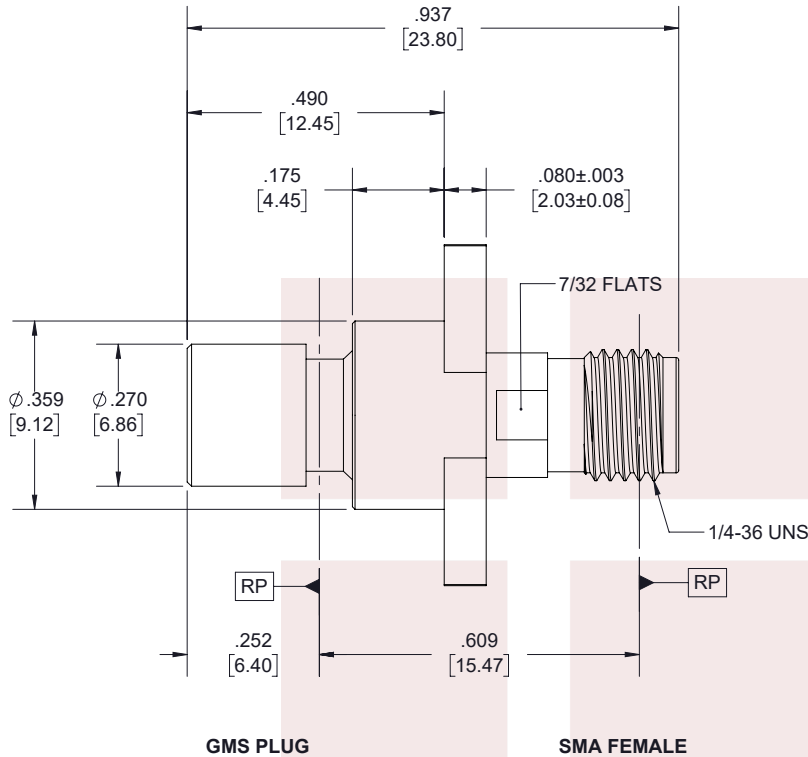

**STANDARD TOLERANCES**

.X ±0.2  
.XX ±0.01  
.XXX ±0.005

\*STANDARD TOLERANCES APPLY  
ONLY TO DIMENSIONS IN INCHES

NOTES:  
1. UNLESS OTHERWISE SPECIFIED ALL DIMENSIONS ARE NOMINAL.  
2. ALL SPECIFICATIONS ARE SUBJECT TO CHANGE WITHOUT NOTICE AT ANY TIME.  
3. DIMENSIONS ARE IN INCHES [mm].

<b>TITLE</b> SMA Female to GMS Male 2 Hole Flange Adapter with Passivated Stainless Steel Body	<b>DWG NO</b> SM2924		<b>CAGE CODE</b> 3FKR5			
	<b>CAD FILE</b> 07/01/19	<b>SHEET</b> 1 OF 1	<b>SCALE</b> N/A	<b>SIZE</b> A	7361	