

ASSEMBLY INSTRUCTIONS

REVISION					
ZONE	REV	DESCRIPTION	DATE	CHANGED BY	APPROVED
	A	INITIAL RELEASE	2/6/2025	KDANG	DWANG

mm [in]

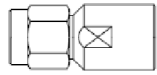

A
BODY

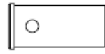

B
SOLDER
FERRULE



C
CLAMP
NUT

DIAGRAM

ASSEMBLY INSTRUCTION



Step 1: STRIP AS SHOWN.

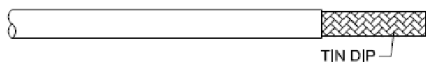

Step 2: TIN DIP SPC BRAID.

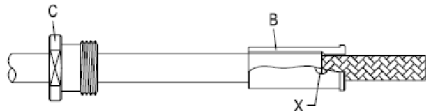

Step 3: SLIDE NUT "C" AND SOLDER FERRULE "B" OVER THE CABLE.
Step 4: SOLDER IN "X".

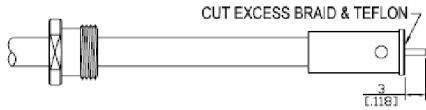

Step 5: CUT AWAY ANY EXCESS BRAID AND TEFLON STICKING OUT OF THE SOLDER FERRULE.
Step 6: CUT CENTER CONDUCTOR TO LENGTH.

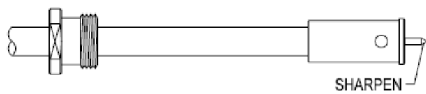

Step 7: SHARPEN CENTER CONDUCTOR TIP.

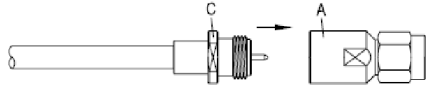

Step 8: FINALLY SCREW NUT "C" ON THE CONNECTOR BODY "A".

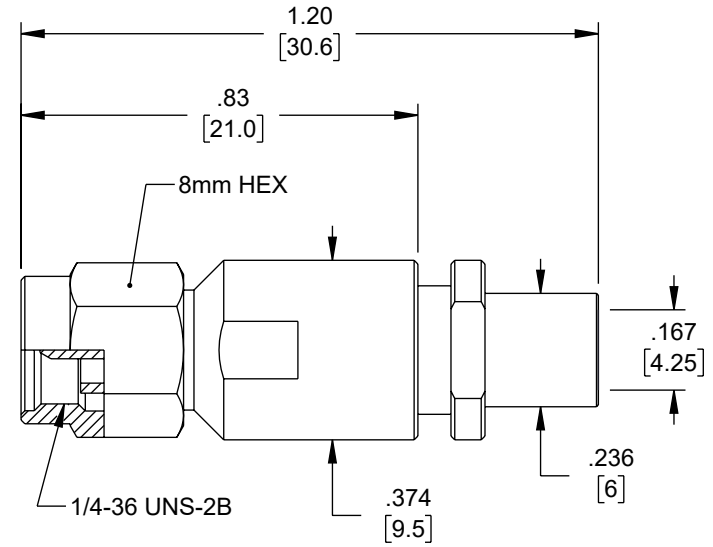

UNLESS OTHERWISE SPECIFIED
LEADING DIMENSIONS ARE INCHES
DIMENSIONS IN [] ARE MILLIMETERS

TOLERANCES:
X = ±.2 [5] FRACTIONS ± 1/32
XX = ±.02 [0.5] ANGLES ± 1°
XXX = ±.005 [0.13]

CABLE LENGTH TOLERANCES:
≤12 [305] = +1 [25] / -0
>12 [305] ≤ 60 [1524] = +2 [51] / -0
>60 [1524] ≤ 120 [3048] = +4 [102] / -0
>120 [3048] ≤ 300 [7620] = +6 [152] / -0
>300 [7620] = +5% / -0

ALL DIMENSIONS ARE FOR REFERENCE ONLY
AND SUBJECT TO CHANGE WITHOUT NOTICE
UN-DIMENSIONED NON-CRITICAL FEATURES
MAY VARY IN SIZE AND LOCATION
COLORS MAY VARY



Website: www.FairviewMicrowave.com
Phone: 1.800.715.4396 | 1.972.649.6678



INTERPRET ALL DIMENSIONS AND
TOLERANCES PER ASME Y14.5

SCALE NONE SHEET 1 OF 1

DESCRIPTION

3.5mm MALE (PLUG) CONNECTOR FOR FLEXIBLE RG402, FM-P141HF, CLAMP/SOLDER

SIZE	CAGE CODE	DRAWN BY	ITEM NO.	REV
A	3FKR5	KDANG	FMCN5331	A

THE INFORMATION CONTAINED IN THIS DRAWING IS THE SOLE PROPERTY OF INFINITE ELECTRONICS, INC. ANY REPRODUCTION IN PART OR WHOLE WITHOUT THE WRITTEN PERMISSION OF INFINITE ELECTRONICS, INC. IS PROHIBITED. THESE COMMODITIES, TECHNOLOGY OR SOFTWARE WERE EXPORTED FROM THE UNITED STATES IN ACCORDANCE WITH THE EXPORT ADMINISTRATION REGULATIONS. DIVERSION CONTRARY TO U.S. LAW PROHIBITED.