

REVISIONS			
REV.	DESCRIPTION	DATE	APPROVED
A	INITIAL RELEASE	04/02/2020	S.ELLIS

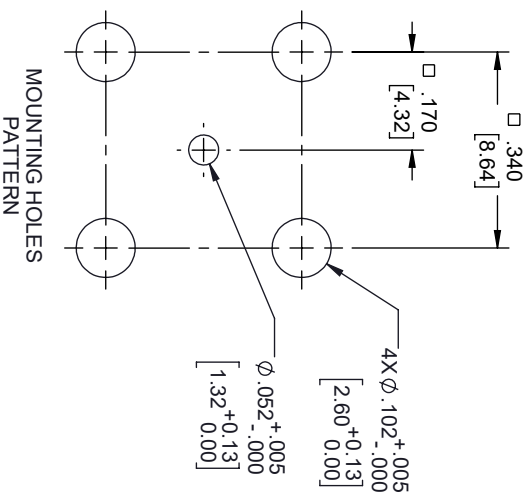

- NOTES:
- FEMALE CONTACT ACCEPTS PIN SIZE  $\phi$ .009 [0.23]  $\nabla$ .071 [1.80] MAX.
  - SEPARATE METAL CONTACT RING.

THESE COMMODITIES, TECHNOLOGY OR SOFTWARE WERE EXPORTED FROM THE UNITED STATES IN ACCORDANCE WITH THE EXPORT ADMINISTRATION REGULATIONS, DIVERSION CONTRARY TO U.S. LAW PROHIBITED.

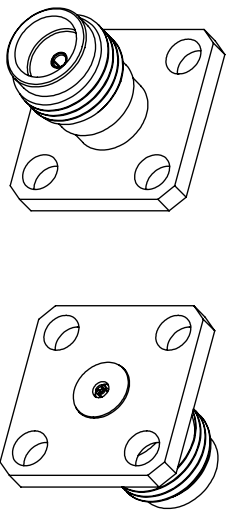
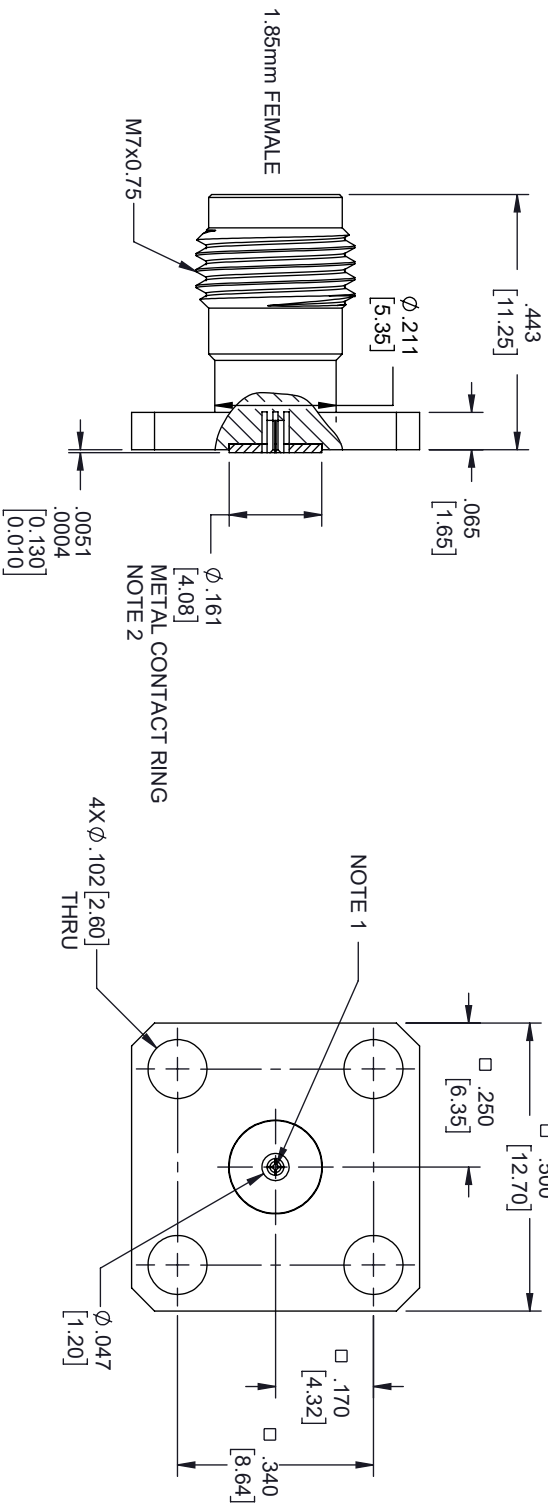

TITLE

X =  $\pm$ .2 [5.08] FRACTIONS  
XX =  $\pm$ .02 [51]  $\pm$  1/32  
XXX =  $\pm$ .005 [13] ANGLES  $\pm$  1°

L  $\leq$  12 [305] =  $\pm$ 1 [25] / -0  
12 [305] < L  $\leq$  60 [1524] =  $\pm$ 2 [51] / -0  
60 [1524] < L  $\leq$  120 [3048] =  $\pm$ 4 [102] / -0  
120 [3048] < L  $\leq$  300 [7620] =  $\pm$ 6 [152] / -0  
300 [7620] < L =  $\pm$ 5%L / -0

ALL DIMENSIONS SHOWN ARE FOR REFERENCE ONLY.				SCALE	
SIZE	CAGE CODE	DRAWN BY	ITEM NO.		REV
A	3FKR5	DZINN	FMCN1680	N/A	A