

INSULATION 1

CENTER CONTACT

INSULATION 2

STRIPPING DIMENSIONS

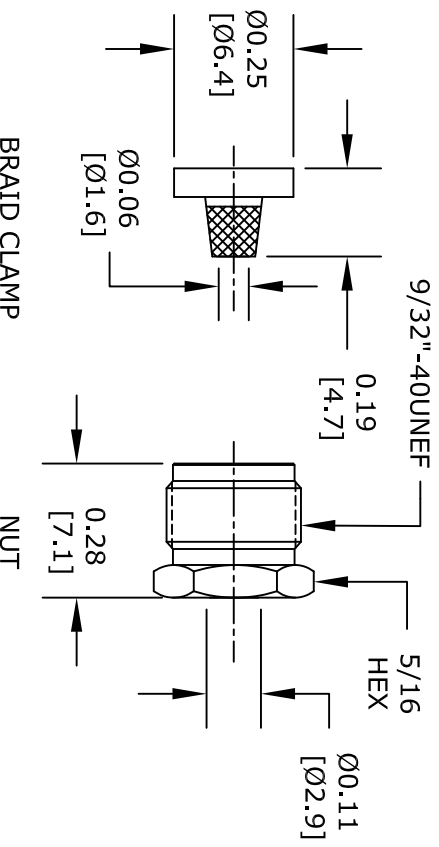

BRAID CLAMP

NUT

ASSEMBLY PROCEDURES

1. STRIP CABLE TO THE DIMENSIONS SHOWN, DO NOT NICK CENTER CONDUCTOR OR BRAID.
2. SLIDE NUT AND BRAID CLAMP ONTO CABLE.
3. FLARE BRAID (FLAT) AND INSTALL 'INSULATION 2' AGAINST THE BRAID AS SHOWN.
4. PUSH CENTER CONDUCTOR FULLY INTO CONTACT AND SOLDER, REMOVE ANY EXCESS SOLDER.
5. INSERT 'INSULATION 1' INTO THE BODY.
6. VERIFY BRAID IS FLAT AND 'INSULATION 2' IS IN POSITION.
7. INSERT THE CONTACT FULLY INTO THE BODY UNTIL IT SEATS.
8. ASSEMBLE BRAID CLAMP AND NUT, CLAMPING THE BRAID AS SHOWN.
9. RECOMMENDED TORQUE: 3 TO 5 IN-LBS.

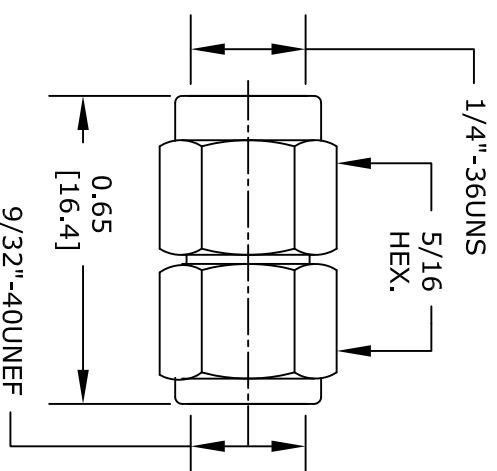

FAIRVIEW MICROWAVE INC.

ALLEN, TX 75013 WWW.FAIRVIEWMICROWAVE.COM

NOTES:
1. UNLESS OTHERWISE SPECIFIED ALL DIMENSIONS ARE NOMINAL.
2. ALL SPECIFICATIONS ARE SUBJECT TO CHANGE WITHOUT NOTICE AT ANY TIME.
3. DIMENSIONS ARE IN INCHES [mm].

TITLE	DWG NO				CAGE CODE			
	FMC01061				3FKR5			
	CAD FILE	102715	SHEET		SCALE	N/A	SIZE	A
								2233