

# ADAPTER, GMS JACK-SMA MALE BULKHEAD ADAPTER

SM2927

## SPECIFICATIONS

**ELECTRICAL**  
 50 OHMS  
 VSWR 1.30:1 MAX  
 FREQUENCY: DC-23 GHZ

**MECHANICAL**

**ENVIRONMENTAL**  
 -65 DEG C TO +165 DEG C

**MATERIALS**  
 BODY: PASSIVATED STAINLESS STEEL  
 CENTER CONTACT: AU PLATED &  
 NICKEL PLATED BeCu  
 INSULATION: TEFLON  
 DURABILITY: 5000 CYCLES

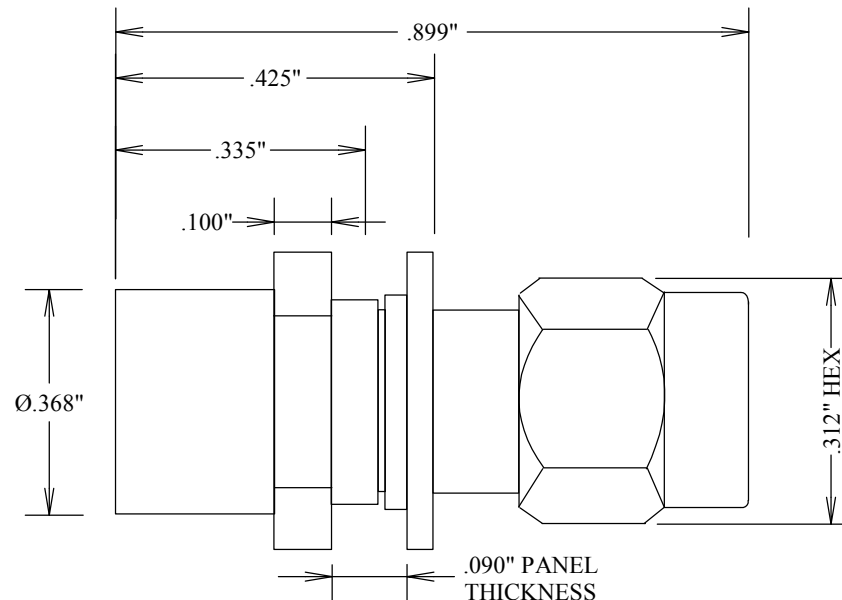
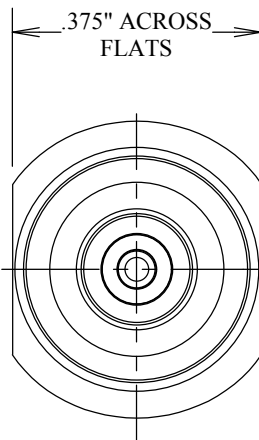

GMS JACK

SMA MALE

				<b>FAIRVIEW MICROWAVE INC.</b>			
				ALLEN, TX 75013 WWW.FAIRVIEWMICROWAVE.COM			
				TITLE			
				<b>ADAPTER, GMS JACK-SMA MALE BULKHEAD ADAPTER</b>			
SIZE	CAGE CODE	DWG NO				REV	
<b>A</b>	<b>3FKR5</b>	<b>SM2927</b>				<b>A</b>	
SCALE						SHEET	