

SPECIFICATIONS

ELECTRICAL:

FREQUENCY: 0-18 GHZ (SA18), 12.4GHZ (SA18B), 8GHZ(SA18C)

VSWR @ 8GHZ : 1.10 TYP, 1.2 MAX (SA18, SA18B, SA18C)

VSWR @ 12.4 GHZ: 1.15 TYP, 1.25:1 MAX (SA18, SA18B)

VSWR @ 18GHZ: 1.35 TYP, 1.50:1 MAX (SA18)

POWER (AVG) 2 WATTS @ 25 DEG C; .5 WATTS @ 125 DEG C

POWER (PEAK) 200 WATTS

VRMS: 1000v

IMPEDANCE: 50 OHMS

ATTENUATION ACCURACY @ 18GHZ (SA18)

+/- 0.5 DB MAX 1-6 DB

+/- 0.75 DB MAX 7-20 DB

+/- 1.0 DBMAX 21-30 DB

ATTENUATION ACCURACY @ 12.4GHZ (SA18, SA18B)

+/- 0.3 DB MAX 1-6 DB

+/- 0.5 DB MAX 7-20 DB

+/- 0.75 DB MAX 21-30 DB

ATTENUATION ACCURACY @ 8GHZ (SA18, SA18B, SA18C)

+/- 0.3 DB MAX 1-6 DB

+/- 0.5 DB MAX 7-20 DB

+/- 0.75 DB MAX 21-30 DB

MECHANICAL:

MATERIAL BODY: PASSIVATED STAINLESS STEEL

MATERIAL RING & CONTACTS: BeCu

CENTER CONTACT: GOLD PLATED PER MIL-G-45204

RESISTIVE ELEMENT: AINi SUBSTRATE TANTALUM Ni RES.

ENVIRONMENTAL:

TEMP: -55 C TO +135 C

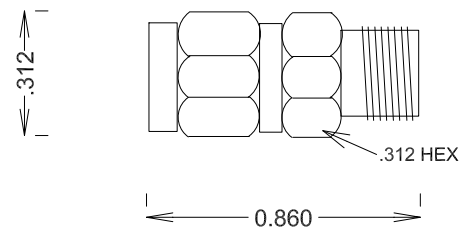

SA18	18GHZ	MAX
SA18B	12.4GHZ	MAX
SA18C	8.0 GHZ	MAX

				FAIRVIEW MICROWAVE INC.	
				ALLEN, TX 75013 WWW.FAIRVIEWMICROWAVE.COM	
				TITLE	
				ATTENUATORS SMA M/F 18 GHZ	
SIZE	CAGE CODE	DWG NO		REV	
A	3FKR5	SA18-XX			
SCALE			SHEET		