

SMA DIRECTIONAL COUPLERS 2-8 GHZ

MC2047-XX

SPECIFICATIONS

ELECTRICAL:

FREQUENCY: 2-8 GHZ
 VSWR 1.25:1 MAX
 POWER CW: 50 WATTS
 POWER PEAK: 3KW
 DIRECTIVITY: 20 DB MIN
 LOSS: THRU: .5DB + COUPLING LOSS
 IMPEDANCE: 50 OHMS

ENVIRONMENTAL:

TEMP: -54 C TO +125 C

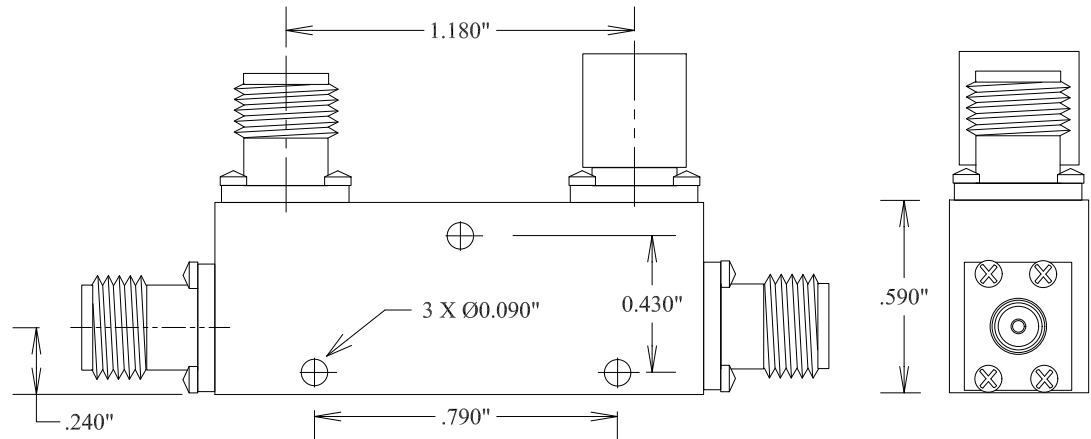
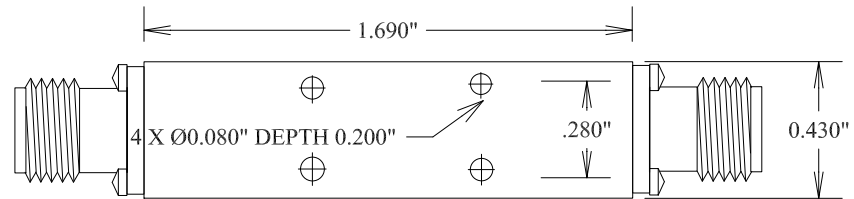

FAIRVIEW MICROWAVE INC.

ALLEN, TX 75013 WWW.FAIRVIEWMICROWAVE.COM

TITLE

SMA DIRECTIONAL COUPLERS 2-8 GHZ

SIZE	CAGE CODE	DWG NO	REV
A	3FKR5	MC2047-XX	A

SCALE

SHEET